

Office365: Configure Outlook 2016 Desktop Application on MacOSKB0011344

Step 1: Open Outlook 2016 Desktop Application for Mac.

Step 2: Enter your email (xyz123@psu.edu).

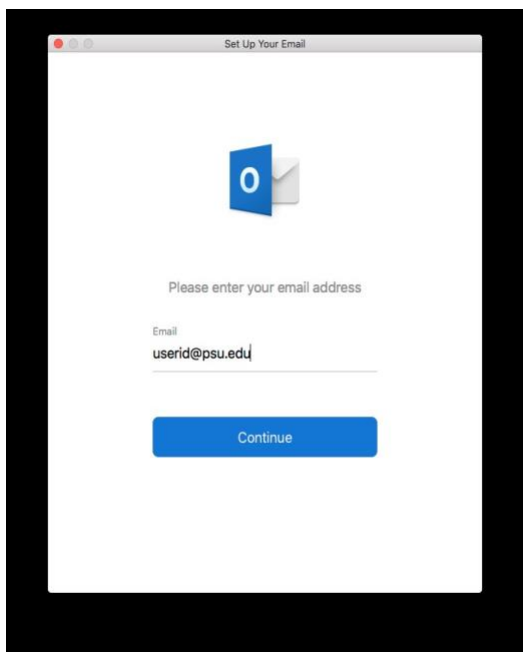

Step 3: Click **Continue**.

Step 4: Enter your **WebAccess credentials**, and if necessary, authenticate with **Duo**.

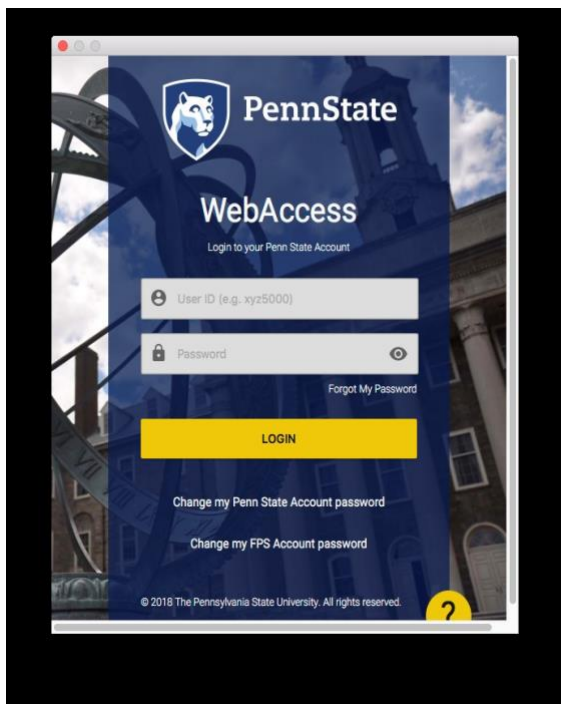

Step 5: All done! Outlook will open and your email will begin downloading. Your calendar will also sync.