

Office365: Configure Gmail App on AndroidKB0011314

Step 1: Tap the menu icon in the upper left corner > **Settings** > **Add account** > **Exchange and Office 365**.

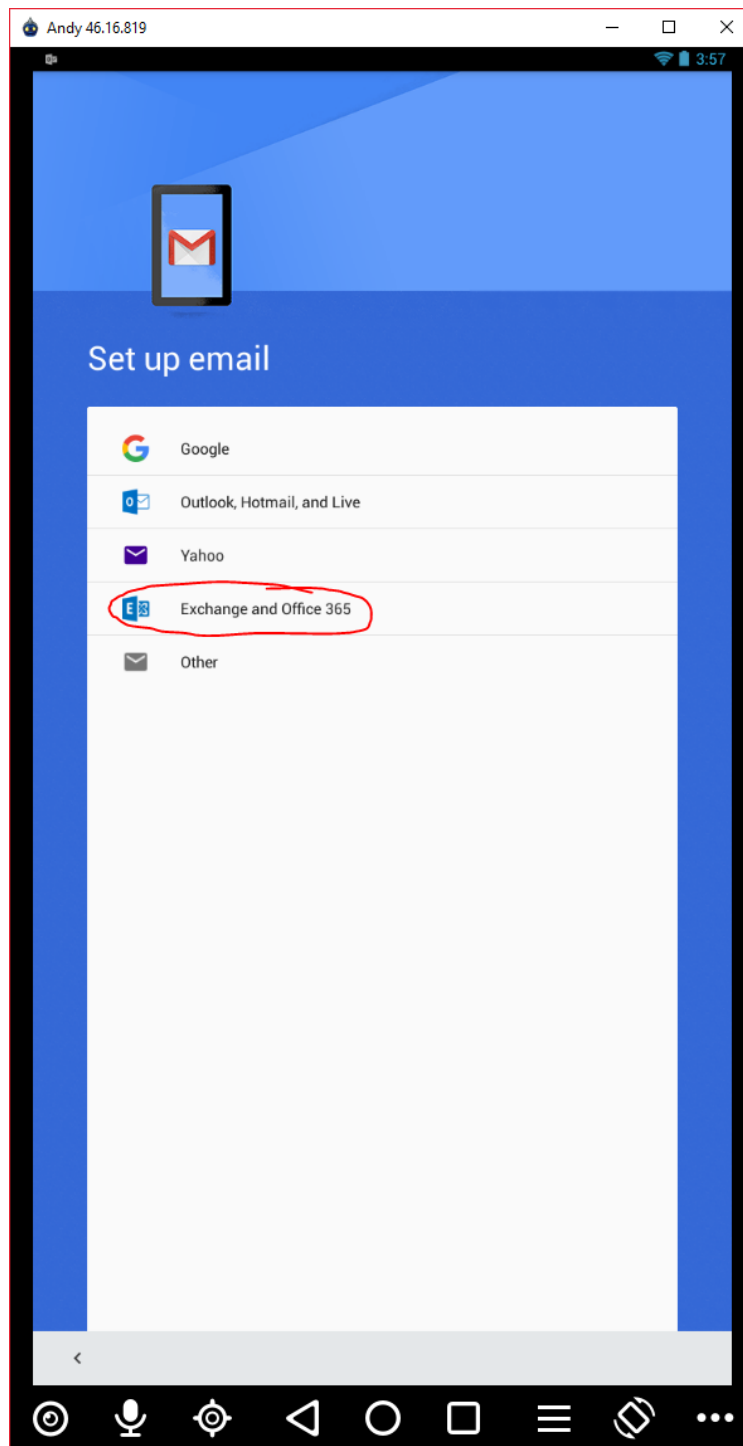

Step 2: Enter your Penn State email address (xyz123@psu.edu) and tap **MANUAL SETUP**.

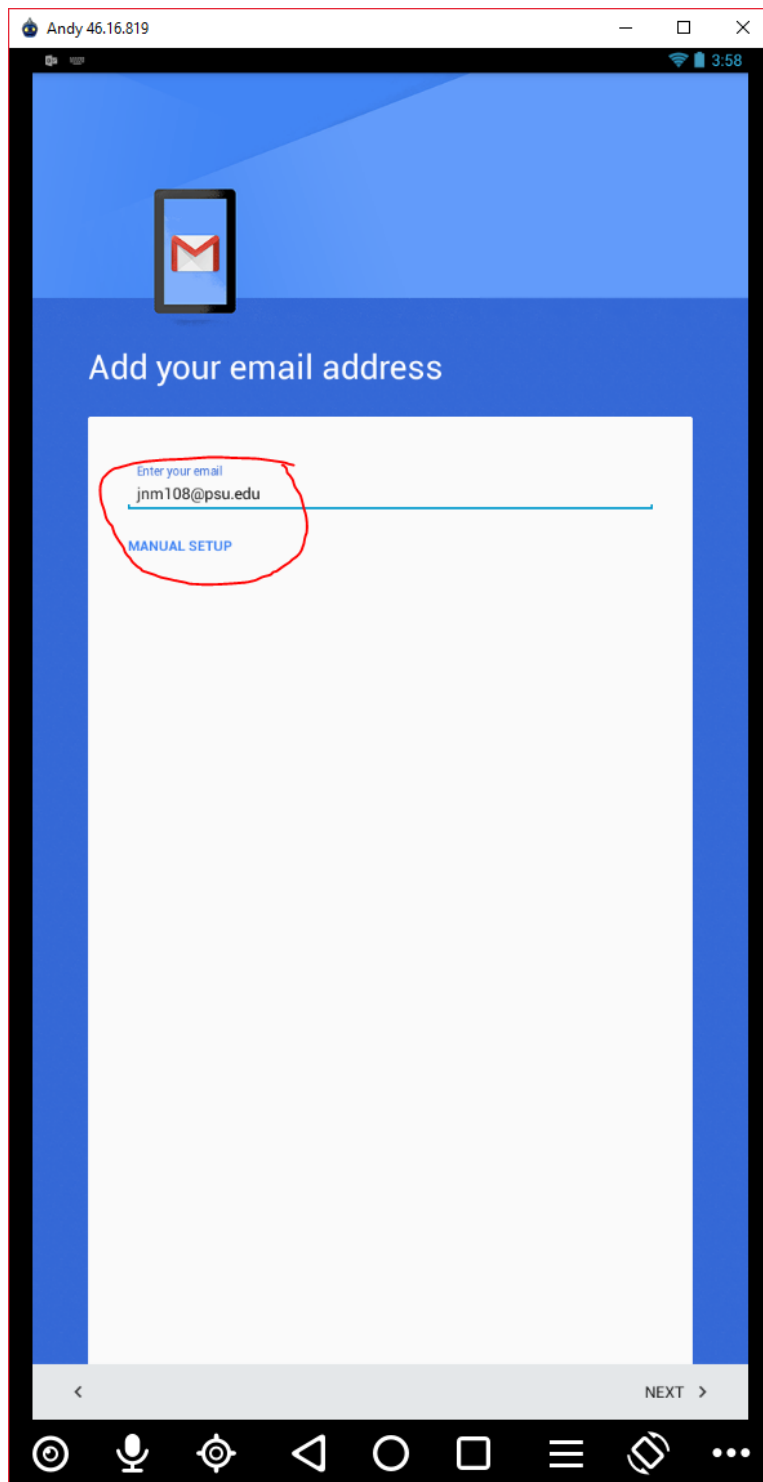

Step 3: Choose the Exchange button and tap **Next**.

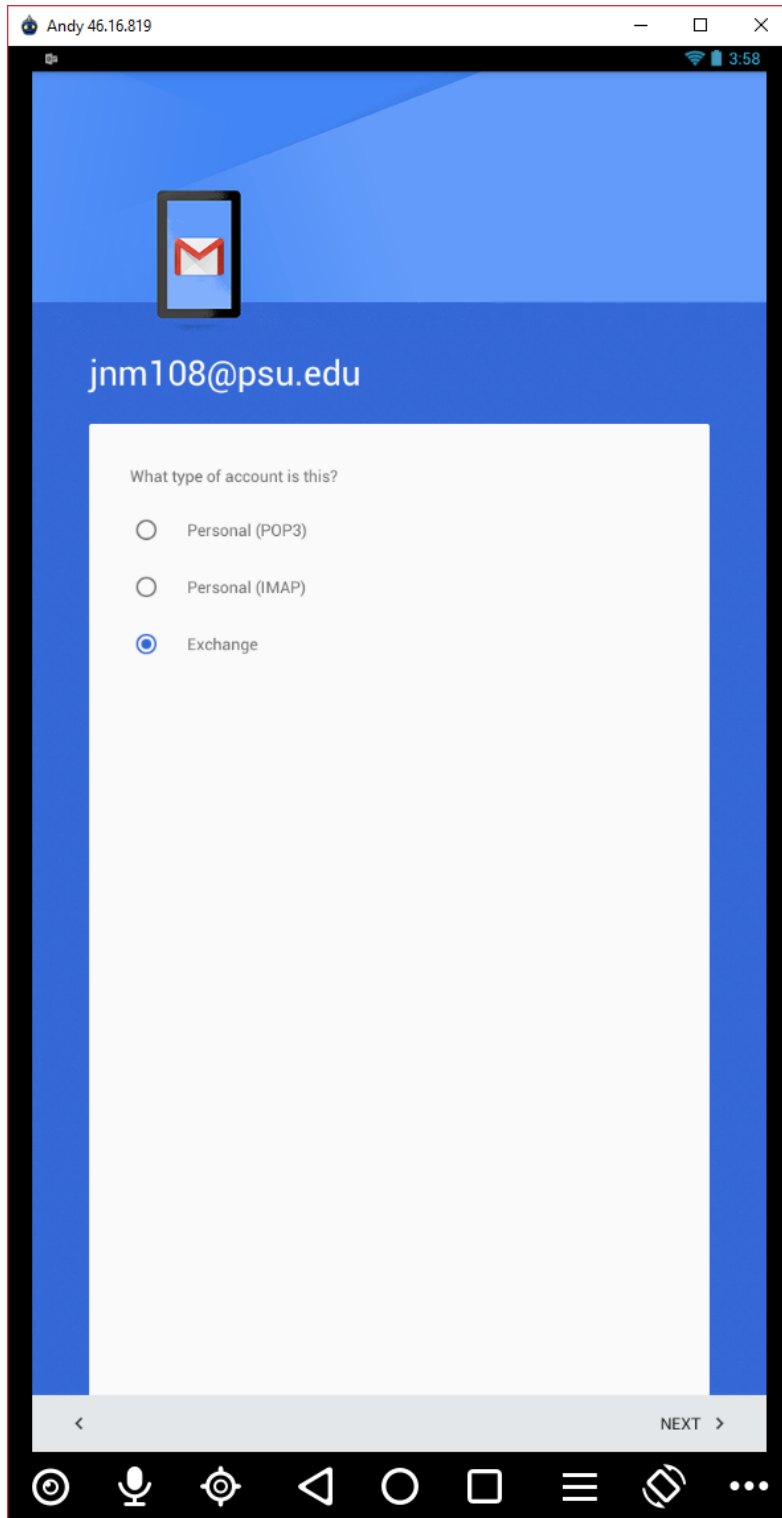

Step 4: Enter your WebAccess password and tap **Next**.

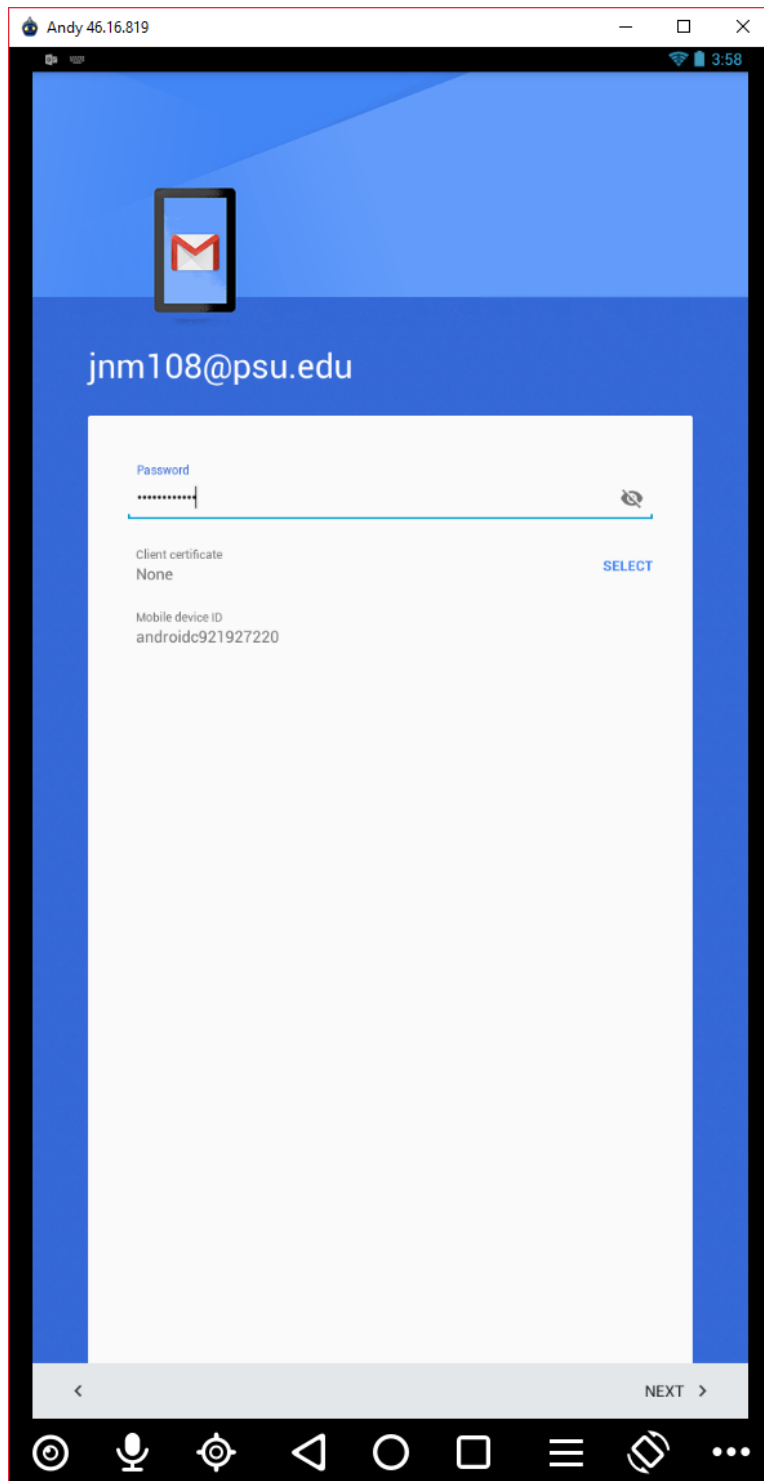

Step 5: For the Server field, enter outlook.office365.com, set the security type to SSL/TLS and make sure your port is 443 then tap **Next**.

Andy 46.16.819

100% 3:59



Incoming server settings

Domain/Username
jnm108@psu.edu

Password
***** 

Client certificate
None [SELECT](#)

Mobile device ID
androidc921927220

Server
outlook.office365.com

Port
443

Security type
SSL/TLS

< NEXT >



Step 6: There will be a prompt for Remote security administration. Tap **OK** to proceed.

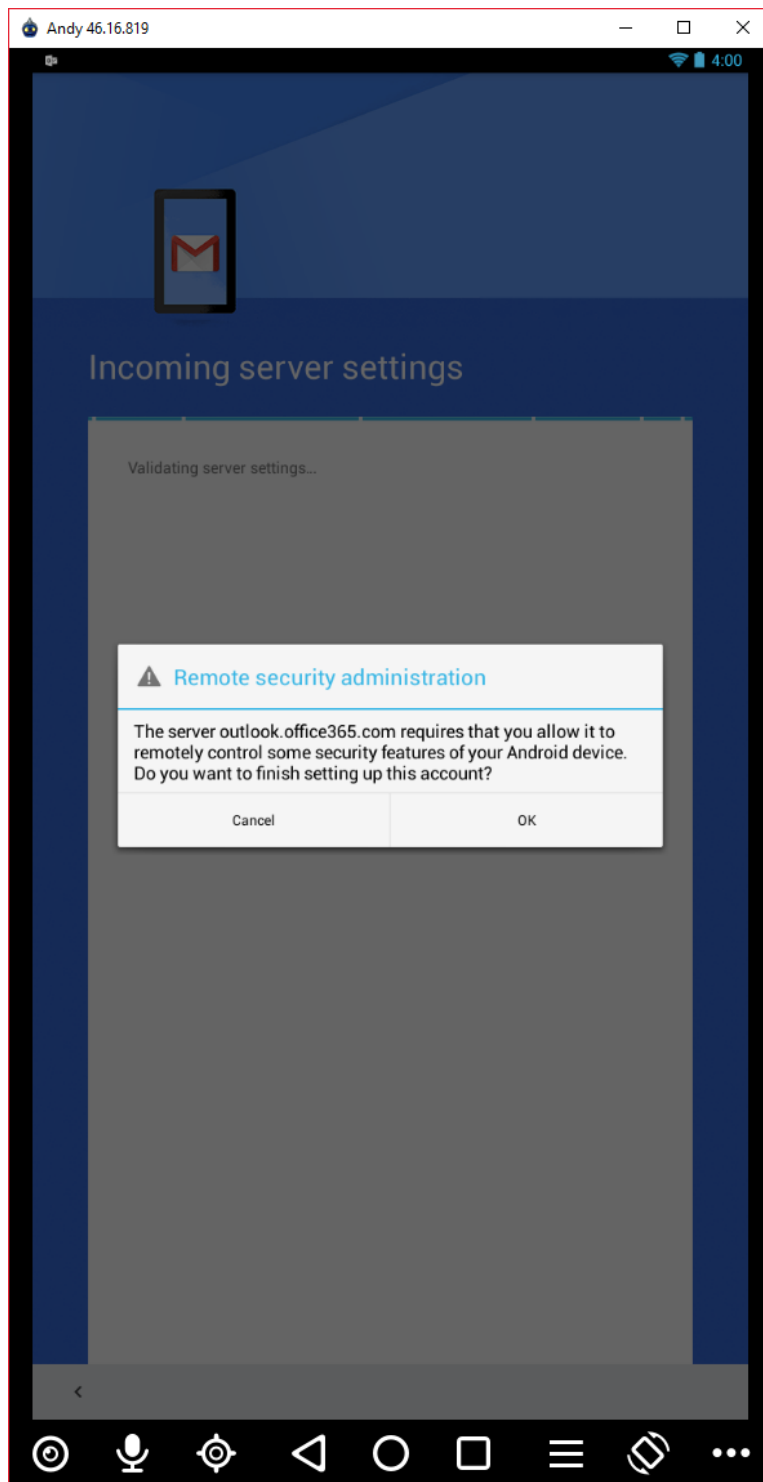

Step 7: Read through the Activate device administrator panel and tap **Activate** if you want to proceed.

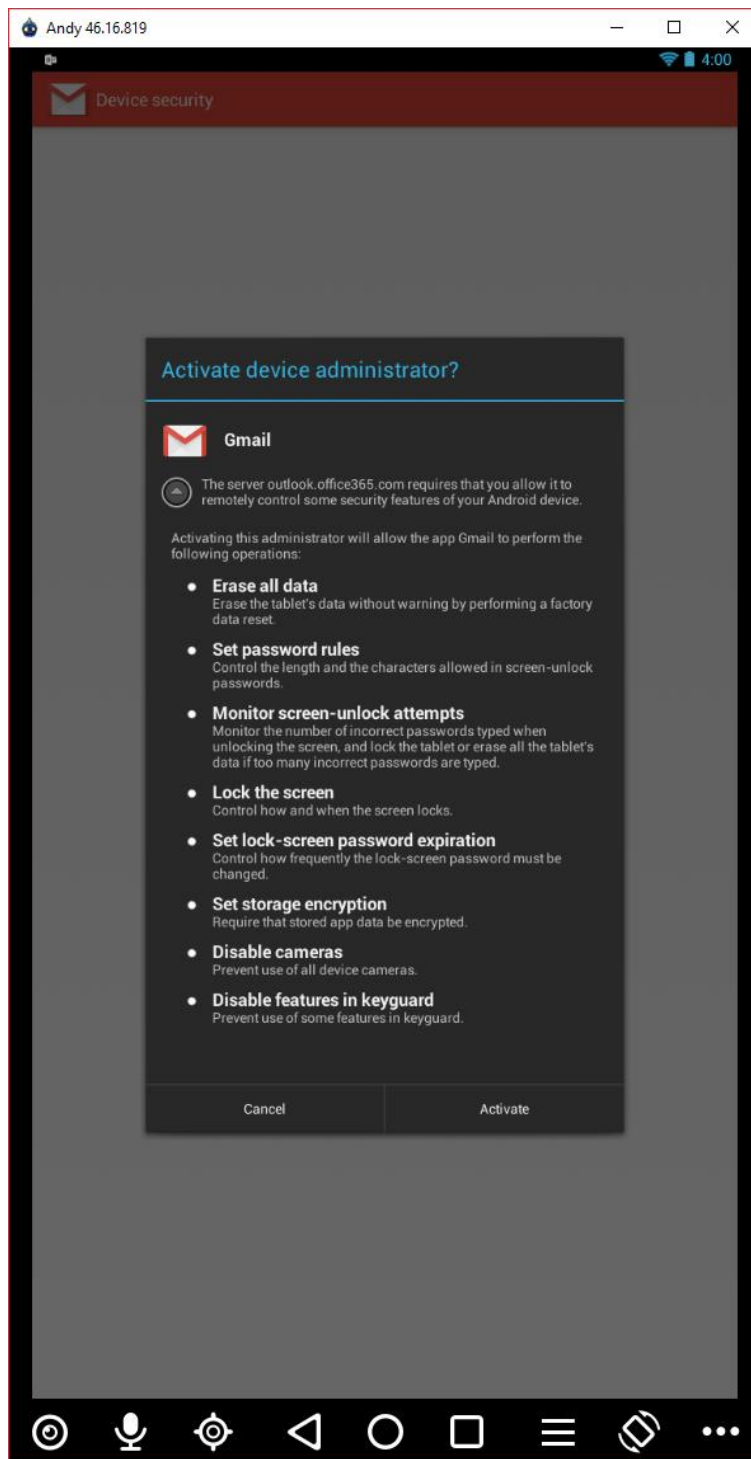

Step 8: Finally choose an Account name and tap **Next**.

